



CIVIL CONSTRUCTION

VOLUME L BID ALTERNATE 12 17TH AVENUE WATER MAIN & SEWER (LRCI 14)

PLAN PACKAGE INDEX / DESCRIPTION	
CIVIL CONSTRUCTION	BID ALTERNATES
VOLUME 1 - EXISTING CONDITIONS & REMOVALS	VOLUME A - NOT USED
VOLUME 2A - CIVIL	VOLUME B - NOT USED
VOLUME 2B - CIVIL	VOLUME C - BID ALTERNATE 3 (LRCI 5) ▲
VOLUME 3A - TRACKWORK	VOLUME D - BID ALTERNATE 4 (LRCI 6) ▲
VOLUME 3B - TRACKWORK	VOLUME E - BID ALTERNATE 5 (LRCI 7) ▲
VOLUME 3C - TRACKWORK DETAILS	VOLUME F - BID ALTERNATE 6 (LRCI 8) ▲
VOLUME 4A - BRIDGES	VOLUME G - BID ALTERNATE 7 (LRCI 4) ▲
VOLUME 4B - BRIDGES	VOLUME H - BID ALTERNATE 8 (LRCI 10) ▲
VOLUME 4C - BRIDGES	VOLUME I - BID ALTERNATE 9 (LRCI 11) ▲
VOLUME 4D - BRIDGES	VOLUME J - BID ALTERNATE 10 (LRCI 12)
VOLUME 4E - BRIDGES	VOLUME K - BID ALTERNATE 11 (LRCI 13)
VOLUME 4F - BRIDGES	VOLUME L - BID ALTERNATE 12 (LRCI 14)
VOLUME 4G - BRIDGES	VOLUME M - BID ALTERNATE 13 (LRCI 26)
VOLUME 5 - TUNNELS	VOLUME N - BID ALTERNATE 14 (LRCI 27)
VOLUME 6 - RETAINING WALLS	VOLUME O - BID ALTERNATE 15 (LRCI 17)
VOLUME 7 - UTILITIES	VOLUME P - BID ALTERNATE 20 (LRCI 32)
VOLUME 8 - DRAINAGE	VOLUME Q - BID ALTERNATE 21 (LRCI 33)
VOLUME 9 - URBAN DESIGN / LANDSCAPE	
VOLUME 10A - TRAFFIC	
VOLUME 10B - LIGHTING *	
VOLUME 11A - STATIONS ▲	
VOLUME 11B - STATIONS	
VOLUME 11C - STATIONS	
VOLUME 11D - STATIONS	
VOLUME 11E - STATIONS	
VOLUME 12 - SYSTEMS	

* TO BE SUBMITTED AT A LATER DATE
 ▲ SUBMITTED AT 75%, NOT INCLUDED IN 90%

THE PROPOSED SOUTHWEST LRT PROJECT IS NOT FINAL BUT IS STILL UNDER ENVIRONMENTAL REVIEW AND THE PROJECT IS SUBJECT TO CHANGE. THESE PLANS ARE NOT FINAL.

THE COUNCIL, THROUGH THE DEVELOPMENT OF THESE PLANS, DOES NOT INTEND THAT THEY WILL PREJUDICE OR COMPROMISE ANY STATE OR FEDERAL ENVIRONMENTAL REVIEW OR OTHER LEGAL REQUIREMENTS. THESE PLANS DO NOT LIMIT THE PROJECT DESIGN ALTERNATIVES OR MITIGATIVE MEASURES THAT THE COUNCIL MAY UNDERTAKE IF THE PROPOSED SWLRT PROJECT PROCEEDS TO CONSTRUCTION.

THE COUNCIL WILL NOT TAKE FINAL ACTION ON THIS MATTER UNLESS THE COUNCIL PROCEEDS WITH THE PROJECT AFTER THE FTA'S RECORD OF DECISION AND THE COUNCIL'S DETERMINATION OF ADEQUACY.

WARNING: THIS RECORD MAY CONTAIN SENSITIVE SECURITY INFORMATION THAT IS CONTROLLED UNDER 49 CFR PARTS 15 AND 1520. NO PART OF THIS RECORD MAY BE DISCLOSED TO PERSONS WITHOUT A "NEED TO KNOW", AS DEFINED IN 49 CFR PARTS 15 AND 1520, EXCEPT WITH THE WRITTEN PERMISSION OF THE ADMINISTRATOR OF THE TRANSPORTATION SECURITY ADMINISTRATION OR THE SECRETARY OF TRANSPORTATION. UNAUTHORIZED RELEASE MAY RESULT IN CIVIL PENALTY OR OTHER ACTION. FOR U.S. GOVERNMENT AGENCIES, PUBLIC DISCLOSURE IS GOVERNED BY 5 U.S.C. 552 AND 49 CFR PARTS 15 AND 1520.

90% SUBMISSION
 DATE : 01/22/16

CITY OF HOPKINS

APPROVED: _____ DATE: _____



Jan, 21 2016 09:06 pm v:\3400_ADC\CAD MANAGEMENT\DRAWING LIST\COVER SHEETS 90%\90% GEN-IDX-LRCI.dwg By: v-kriewomr

CIVIL CONSTRUCTION						CIVIL CONSTRUCTION						CIVIL CONSTRUCTION					
SHT #	SHEET NAME	SHEET DESCRIPTION	STATION	STATION	REV	SHT #	SHEET NAME	SHEET DESCRIPTION	STATION	STATION	REV	SHT #	SHEET NAME	SHEET DESCRIPTION	STATION	STATION	REV
VOLUME L																	
1	00-GEN-CVR-001	COVER SHEET															
2	00-GEN-IDX-001	VOLUME INDEX OF PLAN SHEETS															
3	W0-GEN-KEY-001	GENERAL KEY MAP															
4	W3-UTL-PLN-014-LRCI14	SHADY OAK STATION 1 OF 6 REMOVALS															
5	W3-UTL-PLN-015-LRCI14	SHADY OAK STATION 2 OF 6 REMOVALS															
6	W3-UTL-PLN-016-LRCI14	SHADY OAK STATION 3 OF 6 PLAN															
7	W3-UTL-PLN-017-LRCI14	SHADY OAK STATION 4 OF 6 PLAN															
8	W3-UTL-PLN-018-LRCI14	SHADY OAK STATION 5 OF 6 PROFILES															
9	W3-UTL-PLN-019-LRCI14	SHADY OAK STATION 6 OF 6 PROFILES															

NO.	DATE	BY	CHECK/DESIGN	REVISION / SUBMITTAL



90% SUBMISSION - 01/22/16



CIVIL (BA12)
17TH AVENUE WATER MAIN & SEWER
VOLUME INDEX OF PLAN SHEETS

DISCIPLINE: GENERAL SHEET NAME: 00-GEN-IDX-001

SHEET
2
OF
9

Jan, 18 2016 10:51 am V:\3400_ADC\CAD\CAD MANAGEMENT\DRAWING LIST\COVER SHEETS 90%\WO-GEN-KEY-LRCL-90.dwg By: V-KriewalMR

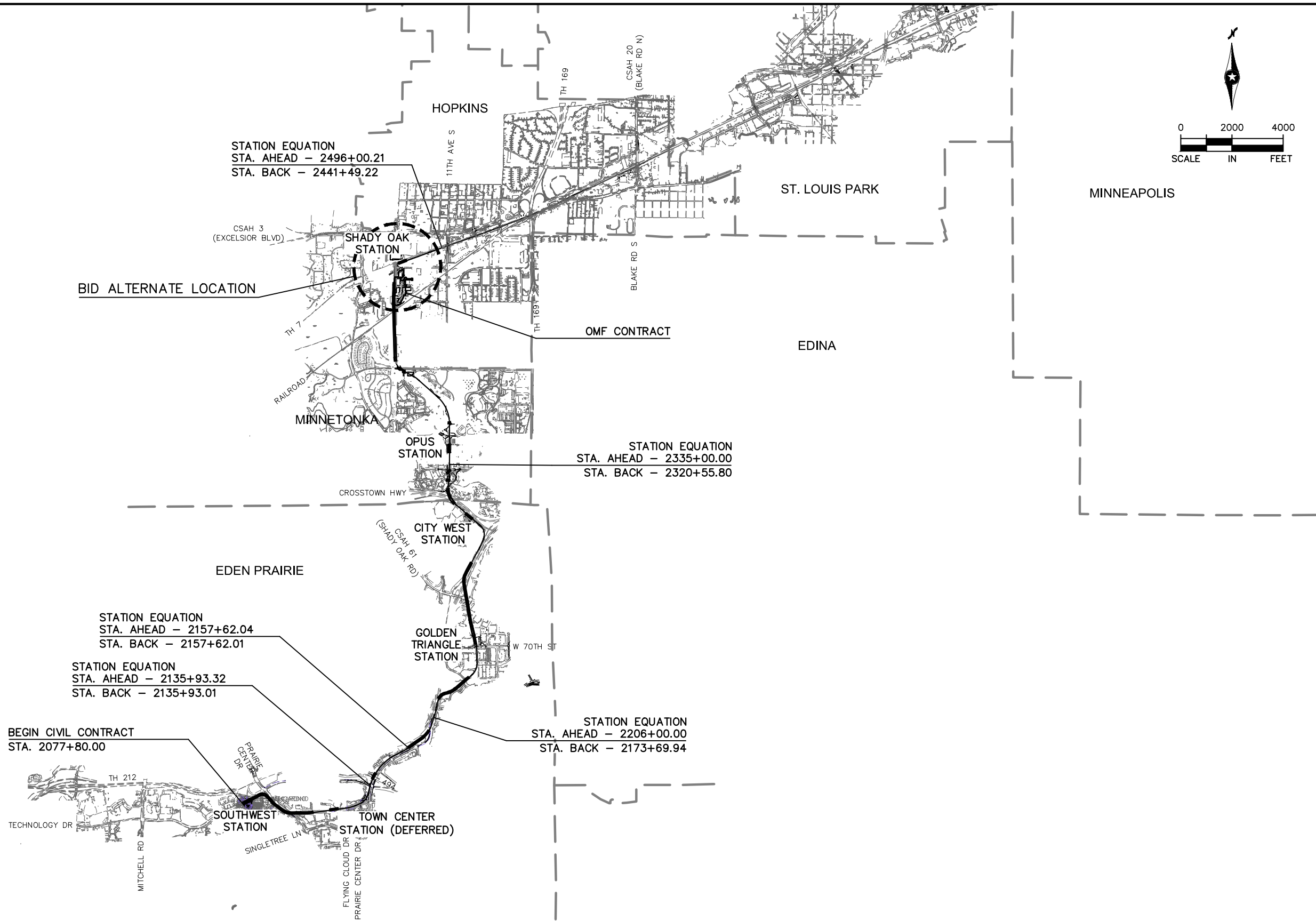

NO.	DATE	BY	CHECK/DESIGN	REVISION / SUBMITTAL

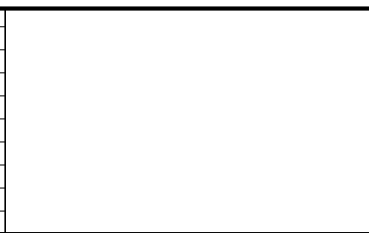

90% SUBMISSION - 01/22/16



CIVIL (BA12)
17TH AVENUE WATER MAIN AND SEWER
GENERAL KEY MAP

DISCIPLINE: **GENERAL** SHEET NAME: **W0-GEN-KEY-001**

SHEET
 3
 OF
 9

NOTES:

* SEE SHEET W0-UTL-NTS-002 FOR UTILITY LEGEND.

* (XX) = SANITARY AND WATER PLAN CONSTRUCTION NOTE. REFER TO SHEET W0-UTL-NTS-002 FOR NOTES.

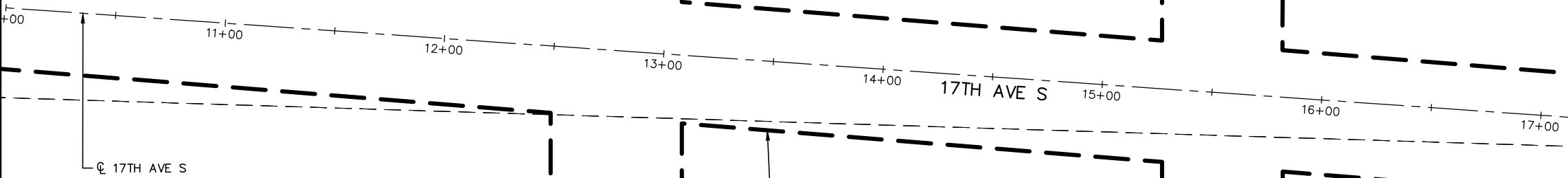

LIMIT OF WORK
BID ALTERNATE 12

CAP MAIN AT REMOVAL LIMIT

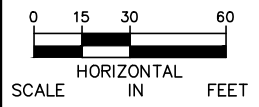

REMOVE HYDRANT AND ASSOCIATED PIPING.
LOCATION/EXTENTS OF PIPING UNKNOWN

REMOVE VALVE AND ASSOCIATED PIPING.
LOCATION/EXTENTS OF PIPING UNKNOWN

REMOVE HYDRANT AND ASSOCIATED PIPING.
LOCATION/EXTENTS OF PIPING UNKNOWN

REMOVE VALVE AND ASSOCIATED PIPING.
LOCATION/EXTENTS OF PIPING UNKNOWN

PLUG TEE AT REMOVAL LIMIT

REMOVALS

NO.	DATE	BY	CHECK/DESIGN	REVISION / SUBMITTAL



90% SUBMISSION - 01/22/16

CIVIL (BA12)
17TH AVENUE WATER MAIN AND SEWER
SHADY OAK STATION 2 OF 6
REMOVALS

DISCIPLINE: UTILITIES

SHEET NAME: W3-UTL-PLN-015-LRC14

SHEET
5
OF
9

Jan, 18 2016 02:31 pm V:\3400_ADC\CAD\LRCI\014\PLAN SHEETS\W3-UTL-PLN-LRC14.dwg By: V-JayannRB

Jan, 18 2016 02:31 pm V:\3400_ADC\CAD\LRCI\014\PLAN SHEETS\W3-UTL-PLN-LRCI14.dwg By: V-JayannRB

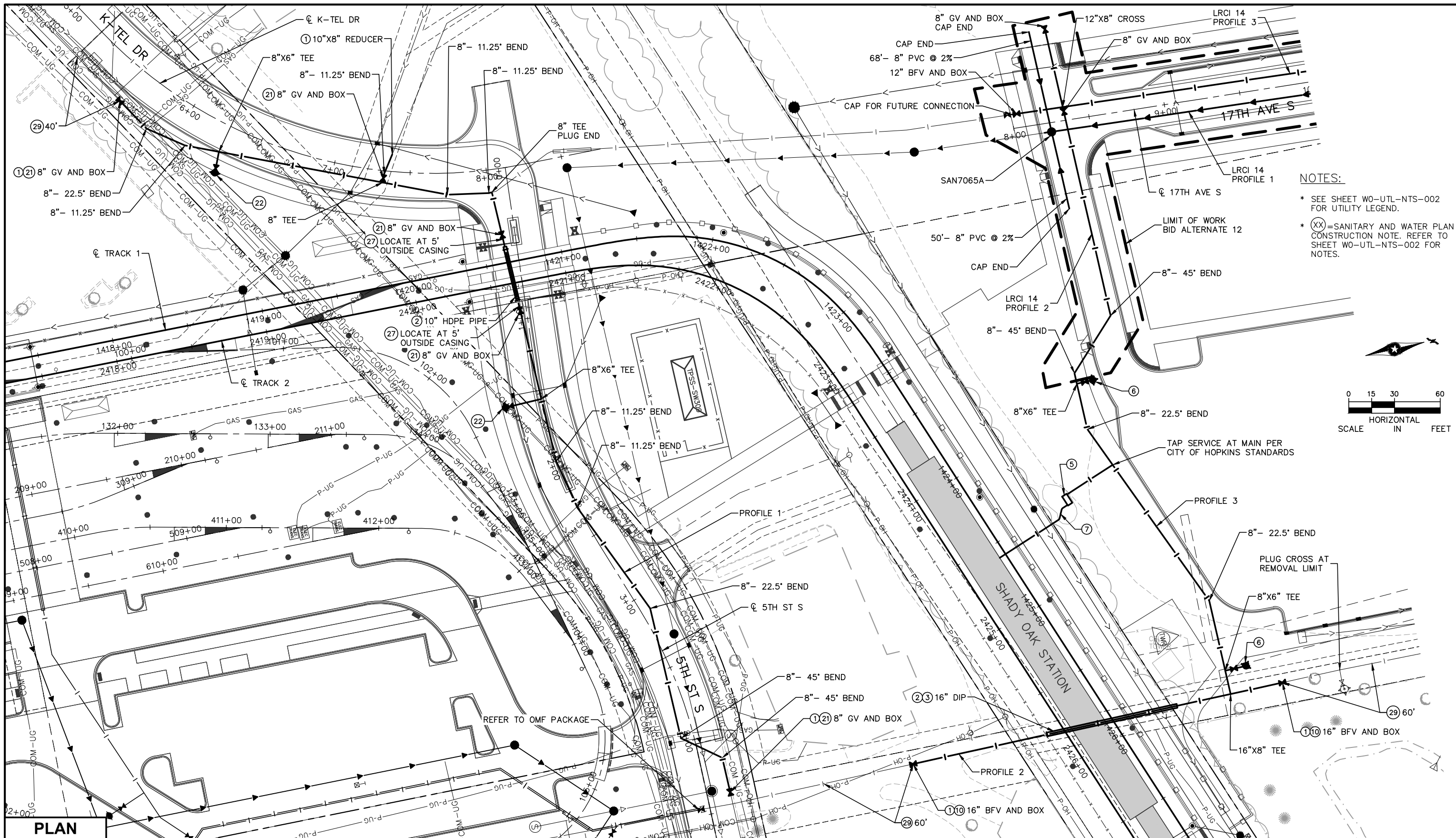

NOTES:
 * SEE SHEET W0-UTL-NTS-002 FOR UTILITY LEGEND.
 * (XX) = SANITARY AND WATER PLAN CONSTRUCTION NOTE. REFER TO SHEET W0-UTL-NTS-002 FOR NOTES.

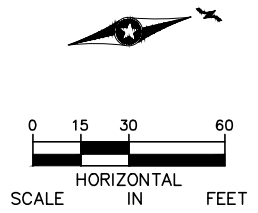

PLAN

NO.	DATE	BY	CHECK	DESIGN	REVISION / SUBMITTAL



AECOM



PCE



METROPOLITAN COUNCIL



SOUTHWEST Green Line Light Extension

90% SUBMISSION - 01/22/16

CIVIL (BA12)

17TH AVENUE WATER MAIN AND SEWER

SHADY OAK STATION 3 OF 6

PLAN

DISCIPLINE: UTILITIES

SHEET NAME: W3-UTL-PLN-016-LRCI14

SHEET

6
OF
9

NOTES:

* SEE SHEET W0-UTL-NTS-002 FOR UTILITY LEGEND.

* (XX) = SANITARY AND WATER PLAN CONSTRUCTION NOTE. REFER TO SHEET W0-UTL-NTS-002 FOR NOTES.

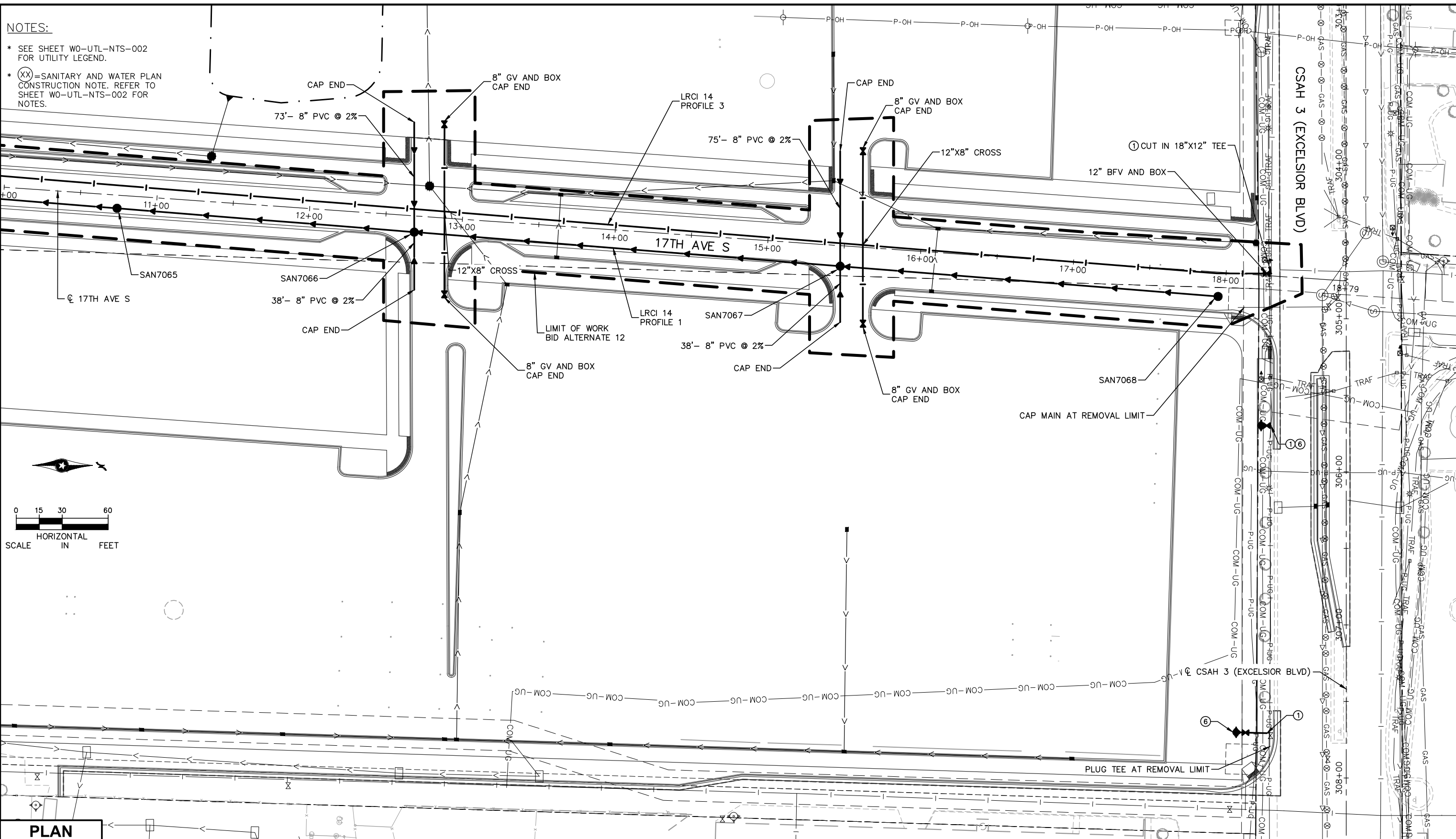

PLAN

NO.	DATE	BY	CHECK/DESIGN	REVISION / SUBMITTAL



90% SUBMISSION - 01/22/16

CIVIL (BA12)
17TH AVENUE WATER MAIN AND SEWER
SHADY OAK STATION 4 OF 6
PLAN

DISCIPLINE: UTILITIES

SHEET NAME: W3-UTL-PLN-017-LRC14

SHEET
7
OF
9

Jan, 18 2016 02:32 pm V:\3400_ADC\CAD\LRCI\LRCI-014\PLAN SHEETS\W3-UTL-PLN-LRC14.dwg By: V-jayannRB

LRCI 14 PROFILE 1

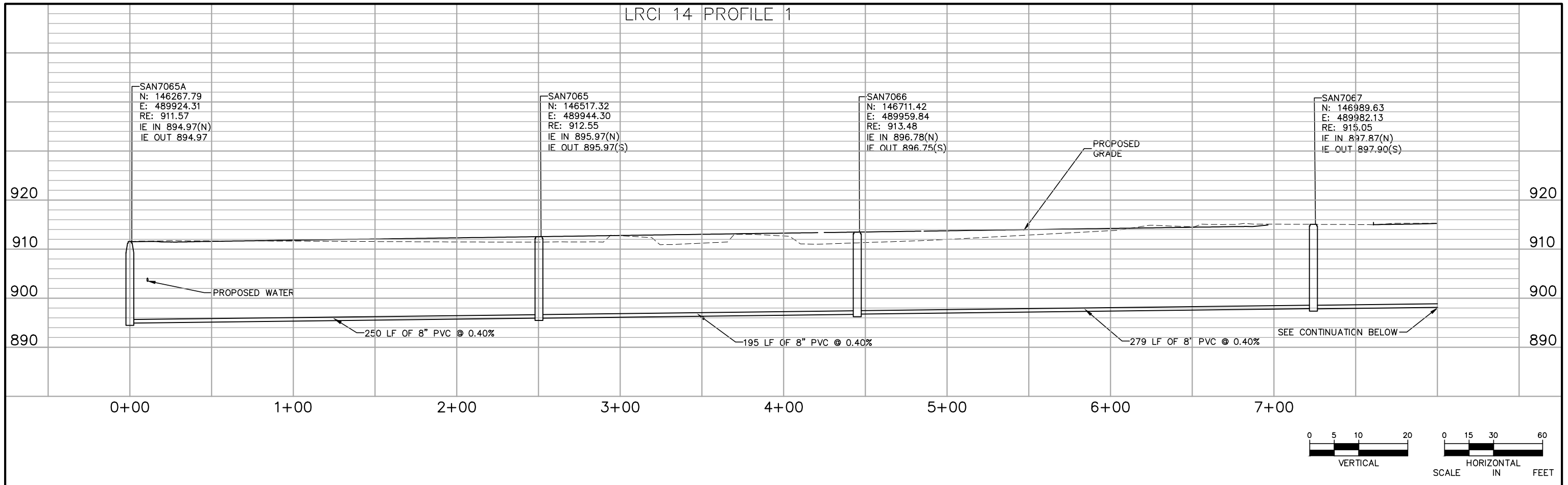

LRCI 14 PROFILE 2

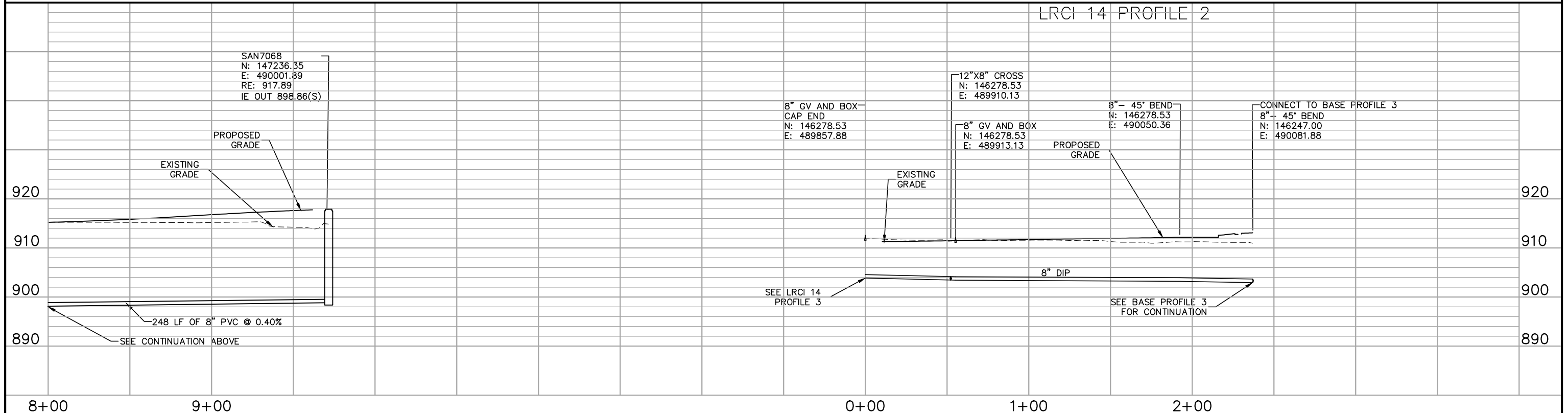

Jan. 18 2016 02:32 pm V:\3400_ADC\CAD\LRCI\LRCI-014\PLAN SHEETS\W3-UTL-PLN-LRCI14.dwg By: V-JayannRB

NO.	DATE	BY	CHECK/DESIGN	REVISION / SUBMITTAL



90% SUBMISSION - 01/22/16



CIVIL (BA12)
 17TH AVENUE WATER MAIN AND SEWER
 SHADY OAK STATION 5 OF 6
 PROFILES

DISCIPLINE: UTILITIES
 SHEET NAME: W3-UTL-PLN-018-LRCI14

SHEET
 8
 OF
 9

LRCI 14 PROFILE 3

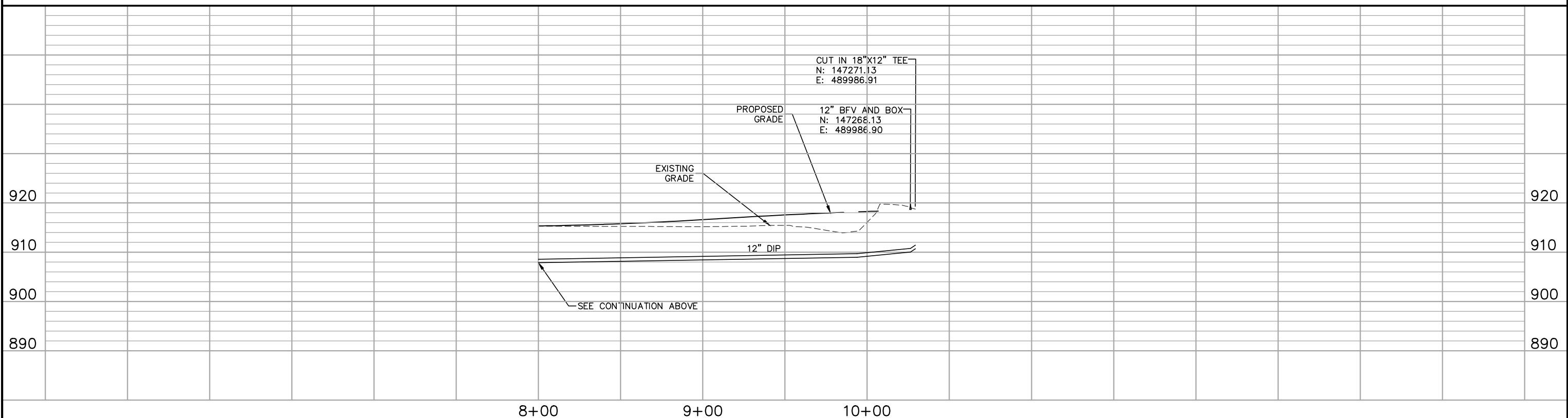
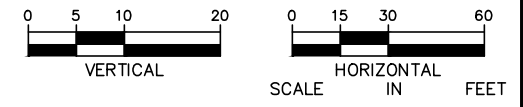
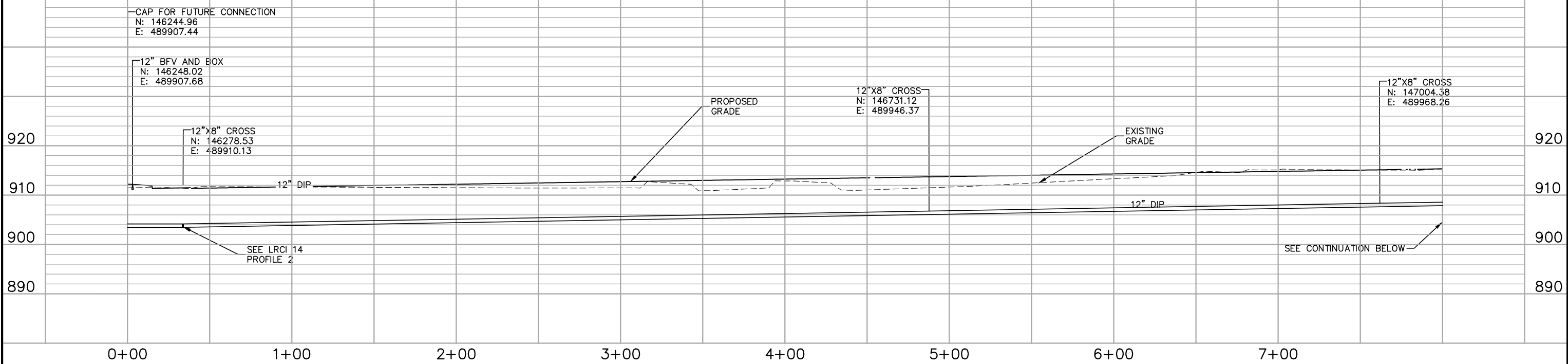

NO.	DATE	BY	CHECK/DESIGN	REVISION / SUBMITTAL



CIVIL (BA12)
17TH AVENUE WATER MAIN AND SEWER
SHADY OAK STATION 6 OF 6
PROFILES

90% SUBMISSION - 01/22/16

DISCIPLINE: UTILITIES SHEET NAME: W3-UTL-PLN-019-LRCI14

SHEET
 9
 OF
 9

Jan. 18 2016 02:32 pm V:\3400_ADC\CAD\LRCI\LRCI-014\PLAN SHEETS\W3-UTL-PLN-LRCI14.dwg By: V-jayannRB